



Tempest 4X

Schematic Drawing

1205 Britannia Rd. E. Mississauga, Ontario, Canada L4W 1C4

Tel.: 1-800-387-3210 Fax: 1-800-709-2896

www.naceinc.com E-mail: info@naceinc.com

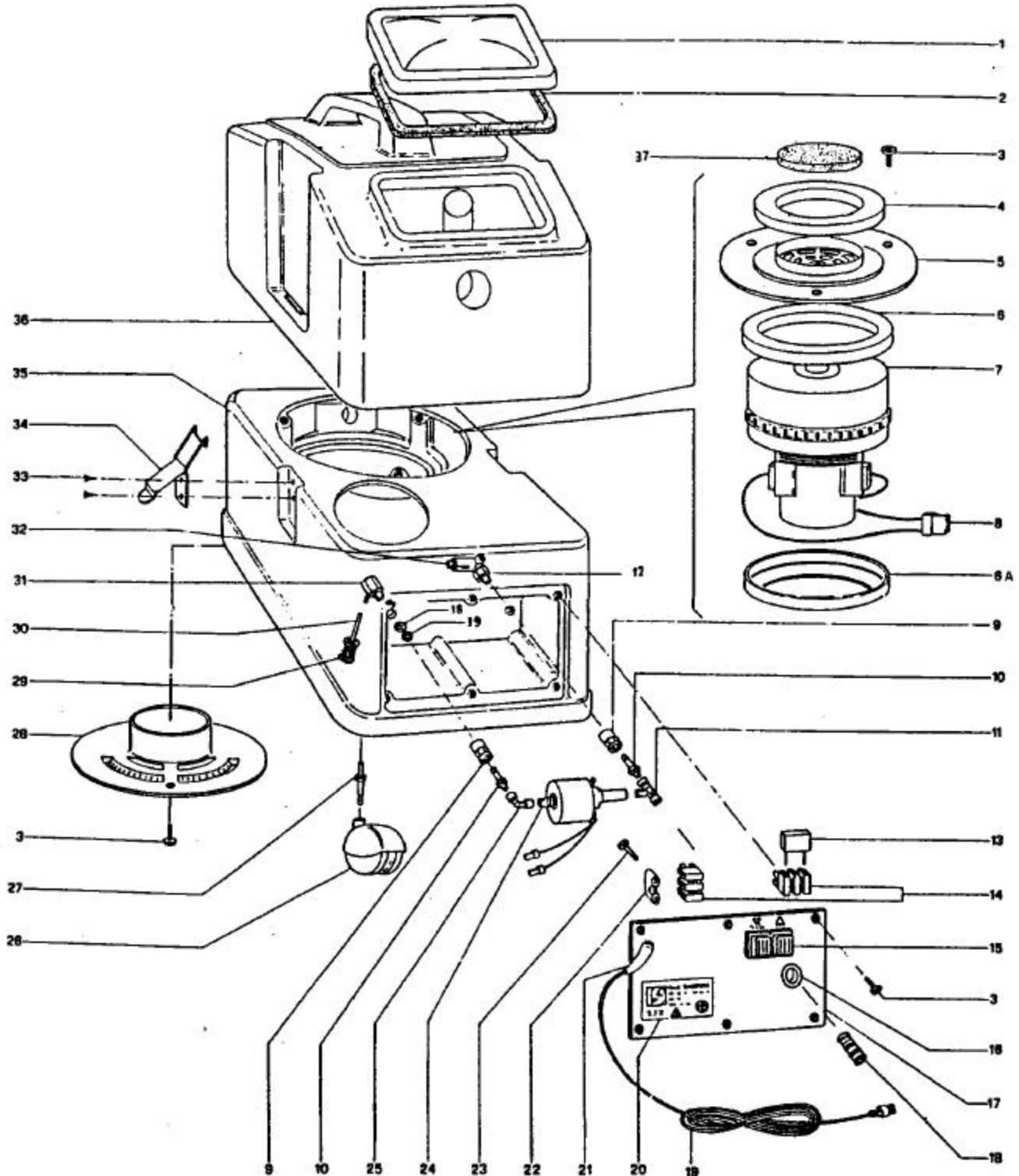



1205 Britannia Rd. E. Mississauga, Ontario, Canada L4W 1C4
 Tel.: 1-800-387-3210 Fax: 1-800-709-2896
 www.naceinc.com E-mail: info@naceinc.com

Tempest 4X

Parts List

Item #	Part #	DESCRIPTION
1	SP-15133	COVER
2	SP-15134	GASKET
3	SP-15536	STAINLESS STEEL SCREW TC+ 4x10
4	SP-15135	GASKET
5	SP-15136	UPPER FLANGE
6	SP-15812	MOTOR GASKET 10mm
6A	SP-15825	MOTOR GASKET 3mm
7	SP-15820	MOTOR 1000W 110V 50/60 Hz
8	SP-15234	CONNECTOR
9	SP-15714	QUICK DISCONNECT FEMALE
10	SP-15698	QUICK DISCONNECT MALE
11	SP-15722	CONNECTING PART
12	SP-15724	CONNECTING PART
13	SP-15235	RADIO INTERFERENCE SUPPR.
14	SP-15236	CONNECTING TERMINAL
15	SP-15217	2 POSITIONS SWITCH
16	SP-15163	BUSH
17	SP-15148	PANEL
18	SP-15700N	EXTENSION FOR METAL QUICK DISC.
18	SP-15687	METAL QUICK DISCONNECT - FEMALE
	SP-15687PE	BRASS PE QUICK DISCONNECT - FEMALE
19	SP-152151	COMPLETE CABLE – US PLUG
20	SP-15139	PANEL LABEL
21	SP-15237	FAIRLEAD
22	SP-15238	CABLE LOCK
23	SP-15537	SCREW
24	SP-15729	PUMP 100-120V 50-60 HZ
24	SP-15729C	PUMP 100-120V WITH FITTINGS
25	SP-15626	ELBOW
26	SP-151140	CASTOR
27	SP-151400	STUD
28	SP-15141	LOWER FLANGE
29	SP-15608	FILTER
30	SP-15701	EXTRAFLEX HOSE
31	SP-15702	CONNECTING PART COMPLETE
32	SP-15640	BY PASS
33	SP-15538	SCREW TC+ 3,9x13
34	SP-15142	TOGGLE
35	SP-15143A	BLUE SOLUTION TANK
36	SP-15144A	BLUE RECOVERY TANK
37	SP-15146	FILTER
38	SP-15147	NEOPRENE WASHER
39	SP-15540	BRASS WASHER