

PULLMAN-HOLT

Replacement Parts List

Save For Future Reference

#30 ASB Bacpac Asbestos Vacuum

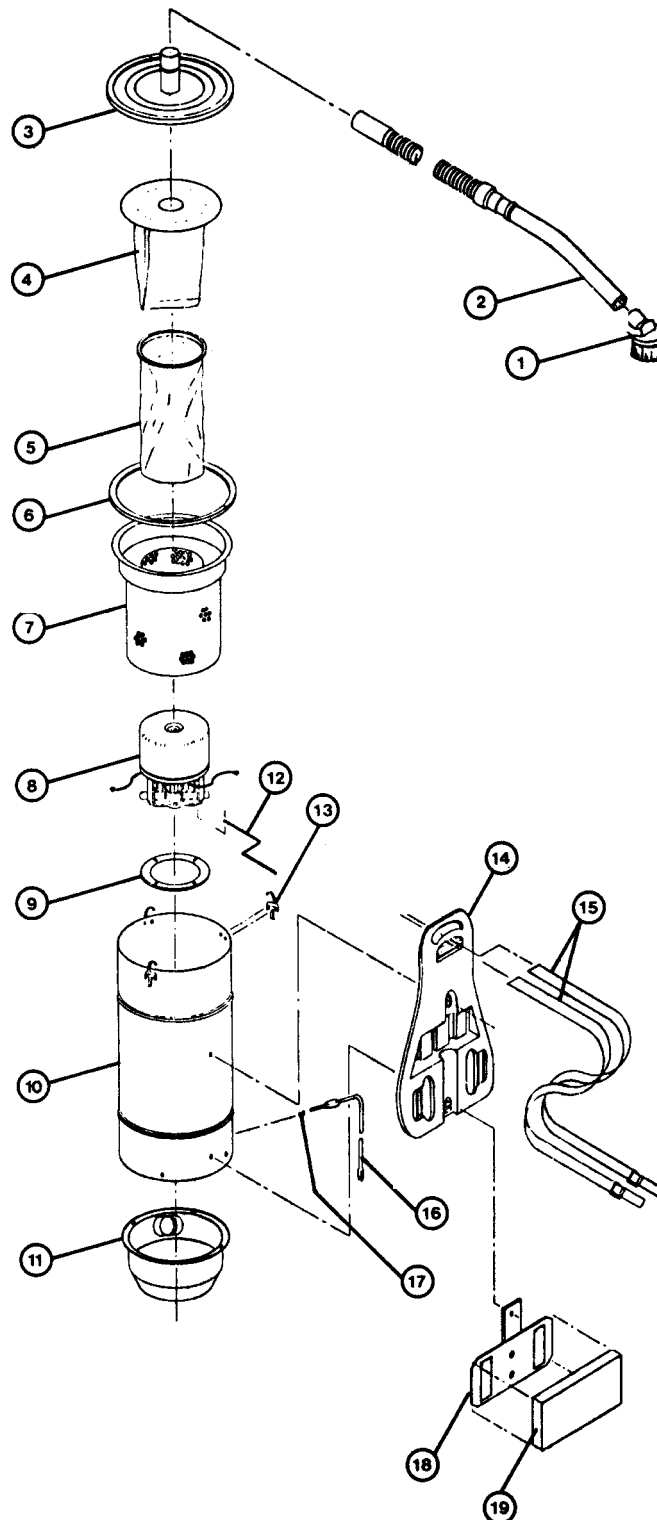

REPLACEMENT PARTS LIST

| Ref. No. | B Part No. | Description | Qty. |
|----------|------------|------------------------|------|
| 1 | B000394 | Dusting Brush Assembly | 1 |
| 2 | B000311 | Hose Assembly | 1 |
| 3 | B260003 | Can Cap Assembly | 1 |
| 4 | B160007 | Disposable Paper Bag | 1 |
| 5 | B700008 | Cloth Filter Bag | 1 |
| 6 | B700003 | HEPA Filter Gasket | 1 |
| 7 | B700000 | HEPA Filter | 1 |
| 8 | B521423 | Motor | 1 |
| 9 | B910092 | Motor Gasket | 1 |
| 10 | B260008 | BacPac Cylinder | 1 |
| 11 | B260016 | Dome Assembly | 1 |
| 12 | B910004 | Ground Wire Assembly | 1 |
| 13 | B521454 | Can Cap Clamp | 3 |
| 14 | B700001 | Bac Pac Harness | 1 |
| 15 | B700002 | Harness Strap | 1 |
| 16 | B260005 | Cord Set Assembly | 1 |
| 17 | B524918 | Strain Relief | 1 |
| 18 | B260018 | Bac Pad Assembly | 1 |
| 19 | B600032 | Foam Pad | 1 |

PULLMAN-HOLT

10702 N 46th Street • Tampa, FL 33617
(813)971-2223 • toll free (800) 237-7582
fax (813) 971-6090 • order entry fax (800) 833-8875
www.pullmanholtcorp.com